

QUALIPOCHE ULD

Ultra long-life felt bag

QUALI FILTRES
SIEBEC Group

EN Data sheet

High thickness filtration bag allowing to increase significantly the life time compared to standard felt bags.



With identical porosity, ULD bags allow to filter thinner and up to 5 times longer.

Comparison of ULD bags with standard felt bags

The following tests have been conducted on a normalized bench on a Ø90 mm disk (1 l/min flow rate and particles concentration ISO CTD of 500 mg/l on average, depending on porosity).

| | 1 µm | 10 µm | 50 µm |
|-----------|-------|--------|--------|
| Life span | + 50% | + 500% | + 250% |

Description

The ULD felt is 30 to 70% thicker than standard felts while increasing the overall permeability (reduction of the initial pressure drop). This structure allows a wider spectrum of particles to be retained in the thickness of the felt: increased depth filtration for delayed clogging. The outer surface of the felt is flamed to prevent any release of fibers.

ULD bags are particularly well adapted to the retention of gels and deformable gelatinous particles.

Characteristics & benefits

- Wide range of porosity from 1 to 100 µm.
- Standard or custom bag.
- W shaped bag available enabling a 60% increase in filtration area.
- Available in 2 materials : polypropylene (POT) and polyester (PET).
- Improved filtration efficiency.
- Life span increased (retention capacity).
- Reduced downtime.
- Reduction of bags consumption.
- Reduction of global filtration costs (consumables + operation)
- Reduction of storage and destruction costs.
- Perfectly suited for the filtration of deformable particles such as gels.
- O-ring available in polypropylene, galvanized steel and stainless steel versions for maximal compatibility with chemicals and high temperatures.
- Available with molded rings according to several industry standards for a better sealing.
- Complies with EU 1935/2004, EU 10/2011 and its amendments, EU 2023/2006 and complies with FDA regulations according to 21 CFR parts 177-1520 and 176-170 (in IW code).
- Made from silicone-free materials.
- Lot number on bags and packaging.

Chemical compatibility

| | Polypropylene | Polyester |
|-----------|---------------|-----------|
| Alkaline | +++ | - |
| Acid | +++ | +++ |
| Oxidizer | - | +++ |
| Solvent | + | ++ |
| Tmax (°C) | 90 | 140 |

+++ Excellent | ++ Good | + Fair | - Not compatible

Note: displayed temperatures are only applicable for metal rings. If polypropylene ring, do not go above 90°C.

Conditions of use

| | |
|-----------------------------------------------|--------------------------------|
| Max pressure loss | 2,4 bar |
| Recommended replacement differential pressure | 0,7 - 1,4 bar |
| Max flow rate | 15 m ³ /h (size 10) |

ORDER REFERENCE

Example :



A / Size

| Code | Diameter (mm) | Length (mm) | Volume (liters) | Area (dm ²) |
|------|---------------|-------------|-----------------|-------------------------|
| 10 | 180 | 450 | 10 | 26 |
| 10W | 180 | 450 | 5 | 40 |
| 20 | 180 | 820 | 19 | 44 |
| 20W | 180 | 820 | 10 | 70 |
| 30 | 260 | 860 | 42 | 65 |
| 40 | 260 | 1070 | 53 | 85 |
| 03 | 95 | 230 | 1.1 | 6 |
| 04 | 107 | 230 | 1.2 | 8 |
| 05 | 110 | 230 | 1.3 | 9 |
| 07 | 95 | 385 | 2.3 | 11 |
| 08 | 107 | 385 | 2.8 | 12 |
| 09 | 110 | 385 | 3.2 | 14 |
| x100 | 152 | 510 | 5.6 | 18 |
| BB10 | 107 | 218 | 1.1 | 6 |
| BB20 | 107 | 457 | 3.8 | 15 |

B / Media

| Code | Material |
|------|--------------------------|
| PET | Thick polyester felt |
| POT | Thick polypropylene felt |

C / Retention threshold

| Code | Porosity |
|------|----------|
| 1 | 1 µm |
| 5 | 5 µm |
| 10 | 10 µm |
| 25 | 25 µm |
| 50 | 50 µm |
| 100 | 100 µm |

D / Ring

| Code | O-ring | Available sizes |
|------|------------------|-----------------|
| EH | Galvanized steel | All |
| S | Stainless steel | All |
| P | Polypropylene | All |

| Code | Molded ring | Available sizes |
|------|-------------------------|-------------------|
| ERP | Profile 1 [PP] | 10 / 20 |
| ERS | Profile 1 [PES] | 10 / 20 |
| PR | Profile 1 [Santoprene™] | 10 / 20 |
| EFS | Profile 2 [PP] | 10 / 20 / 04 / 08 |
| EFSE | Profile 2 [PES] | 10 / 20 / 04 / 08 |
| X10P | Profile 3 [PP] | X100 |
| EAP | Profile 4 [PP] | 10 / 20 |
| EAPE | Profile 4 [PES] | 10 / 20 |
| EAS | Profile 4 [Santoprene™] | 10 / 20 |

E / Options

| Code | Description |
|------|--------------------------------------------------------------------------------------------------|
| IW | Indicates that the bags are wrapped individually. If not mentioned, bags are wrapped in batches. |
| LG | Standard filter bags with increased length. |

PROFILE 1

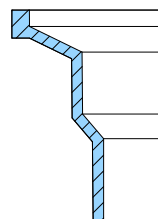

PROFILE 2

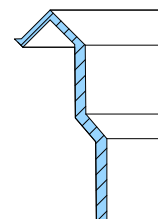

PROFILE 3

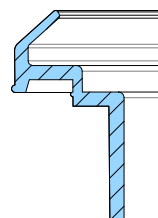
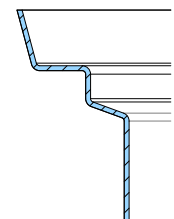

PROFILE 4

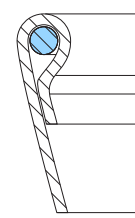

O-RING