

## High-performance polypropylene filtration bag



### Conditions of use

Max pressure loss	2 bar
Recommended replacement differential pressure	0,7 - 1,2 bar
Max flow rate	5 m <sup>3</sup> /h (size 10)

### Description

The internal filtering part is made up of 5 to 8 layers of meltblown and nanofiber filtering materials. The construction of the bag allows a deep retention through the successive layers in order to maximize the retention capacity of the impurities and to prolong the life span. The first layers are made of very thick meltblown materials to retain a maximum of coarse particles. The final layers of the POHE5000 range are made of a nanofiber filtering material allowing to reach an exceptional efficiency of 99.98%.

The meltblown and nanofiber filtering materials have been carefully selected and tested by our analysis laboratory in order to guarantee a filtration efficiency of 99.98% at the announced porosity (BETA RATIO = 5000). The results of the tests carried out on a standardized bench are available on request.

The upstream part consists of a protective spunbond pre-filter layer.

The downstream part consists of a spunbond polypropylene support to avoid any release of fibers and an additional polypropylene mesh to ensure perfect drainage over the entire surface of the bag.

Made of 100% polypropylene and without any seams, QUALIPOCHE HE5000 bags guarantee silicone-free filtration and are also perfectly adapted to food applications.

### Characteristics & benefits

- Filtration efficiency of 99,98% at the indicated porosity.
- Beta ratio of 5000 at the indicated porosity.
- Porosity wide range from 0,5 to 3 µm.
- 100% polypropylene.
- Welded design to prevent all risks of contamination.
- Available with O-ring or molded ring for a reinforced seal.
- Complies with EU 1935/2004, EU 10/2011 and its amendments, EU 2023/2006 (in IW code).
- Made from silicone-free materials.
- Lot number on bags and packaging.

### Chemical compatibility

	Polypropylene
Alkaline	+++
Acid	+++
Oxidizer	-
Solvent	+
Tmax (°C)	90

+++ Excellent | ++ Good | + Fair | - Not compatible

Note: displayed temperatures are only applicable for metal rings. If polypropylene ring, do not go above 90°C.

## ORDER REFERENCE

Example :

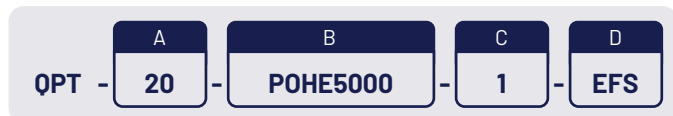

## A / Size

Code	Diameter (mm)	Length (mm)	Volume (liters)	Area (dm <sup>2</sup> )
10	180	450	10	26
20	180	820	19	44
30	260	860	42	65
40	260	1070	53	85
03	95	230	1.1	6
04	107	230	1.2	8
05	110	230	1.3	9
07	95	385	2.3	11
08	107	385	2.8	12
09	110	385	3.2	14
x100	152	510	5.6	18

## B / Media

Code	Material
POHE5000	High performance polypropylene felt series 5000

## C / Retention threshold

Code	Porosity
05	0,5 µm
1	1 µm
3	3 µm

## D / Ring

Code	O-ring	Available sizes
EH	Galvanized steel	All
S	Stainless steel	All
P	Polypropylene	All

Code	Molded ring	Available sizes
ERP	Profile 1 [PP]	10 / 20
ERS	Profile 1 [PES]	10 / 20
PR	Profile 1 [Santoprene™]	10 / 20
EFS	Profile 2 [PP]	10 / 20 / 04 / 08
EFSE	Profile 2 [PES]	10 / 20 / 04 / 08
X10P	Profile 3 [PP]	X100
EAP	Profile 4 [PP]	10 / 20
EAPE	Profile 4 [PES]	10 / 20
EAS	Profile 4 [Santoprene™]	10 / 20

## E / Options

Code	Description
IW	Indicates that the bags are wrapped individually. If not mentioned, bags are wrapped in batches.
LG	Standard filter bags with increased length.

PROFILE 1

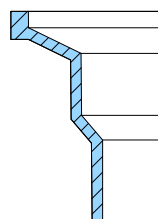

PROFILE 2

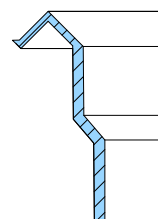

PROFILE 3

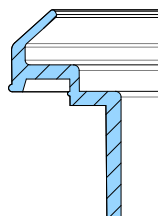
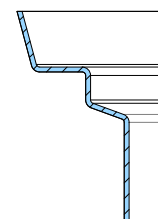

PROFILE 4

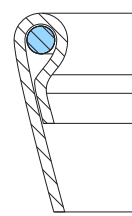

O-RING